

**Fig. 121 RHT 304 Stainless Steel
Threaded "Anchor or Guide" Hanger
One piece unit with threaded adaptor. Rod is sold separately**



Housing with Black inserts are "Anchor" supports

Features: The threaded mounting section, on top of clamp shell, doubles as a threaded rod connector and a welding platform. This type rod connection does not offer the dynamic slope adjustment feature. Figure 121 RHT, with a rod, can also be used in combination with the figure 125 or 126 stanchions. This combination will allow the support to be adjusted telescopically to the tube or pipe elevation. Call customer service for the price and availability of special rod lengths.

Size Range: 0.24" diameters through 6.125" diameter covering imperial tube and pipe size and metric ISO and DIN sizes

Hardware: 316 stainless steel, 304 stainless steel and carbon steel as an option

Finish: Stainless steel at a 25 RA

Plastic: Polysulfone (Black; Anchor and Gray; Guide)

Shearing: Anchors - Refer to shear force diagram in technical section
Guides - Allow for thermal expansion of tube or pipe



Housing with Gray inserts are "Guide" supports

Fig 121RHT "Rigid Thread Mounted" Hanger - Part Number Configurator

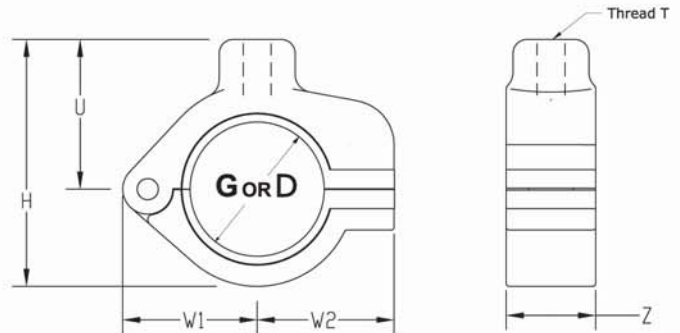
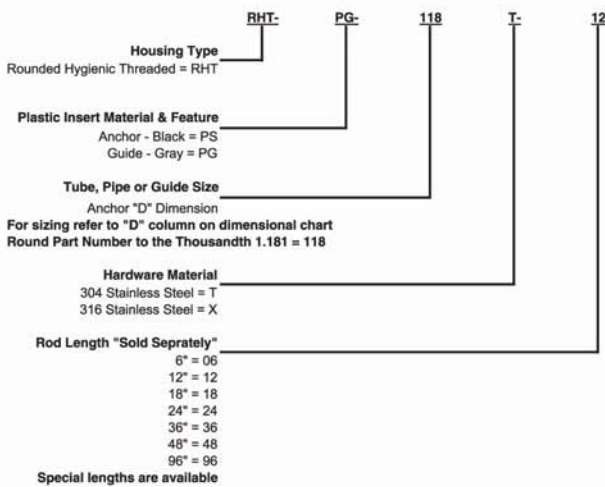

Group No.	Stainless Tube	Pipe	Copper Tube	ISO 1127 / DIN 11850	121 RHT	UNIVERSAL DIMENSIONS AMONGST HOUSINGS			121 RHT	121 RHT	121 RHT	121 RHT	121 RHT
					Part Number	"D" Anchor Plastic	"G" Guide Plastic	W1	W2	Z	U	H	T
1	1/4"			6 mm	RHT-PS-024-T	0.236	0.258	1.01 (26 mm)	1.02 (26 mm)	1.00 (25.4 mm)	1.30 (33 mm)	1.89 (48 mm)	0.35 (0.16 kg)
				8 mm	RHT-PS-025-T	0.250	0.272						
					RHT-PS-032-T	0.315	0.337						
					RHT-PS-038-T	0.375	0.397						
					RHT-PS-039-T	0.393	0.415						
					RHT-PS-047-T	0.472	0.494						
2	1/2"			10 mm	RHT-PS-050-T	0.500	0.522	1.13 (29 mm)	1.15 (29 mm)	1.00 (25.4 mm)	1.40 (36 mm)	2.21 (54 mm)	0.40 (0.18 kg)
				12 mm	RHT-PS-051-T	0.512	0.534						
				13 mm	RHT-PS-054-T	0.540	0.562						
3	3/4"			14 mm	RHT-PS-055-T	0.552	0.574	1.26 (32 mm)	1.28 (33 mm)	1.00 (25.4 mm)	1.50 (38 mm)	2.34 (59 mm)	0.45 (0.20 kg)
				15 mm	RHT-PS-059-T	0.590	0.612						
				16 mm	RHT-PS-063-T	0.625	0.647						
				18 mm	RHT-PS-071-T	0.708	0.730						
				19 mm	RHT-PS-075-T	0.750	0.772						
				20 mm	RHT-PS-079-T	0.787	0.809						
4	1"			21.3 mm	RHT-PS-084-T	0.840	0.862	1.5 (38 mm)	1.54 (39 mm)	1.00 (25.4 mm)	1.67 (42 mm)	2.76 (70 mm)	0.50 (0.23 kg)
				22 mm	RHT-PS-087-T	0.866	0.888						
				23 mm	RHT-PS-088-T	0.875	0.897						
				24 mm	RHT-PS-091-T	0.905	0.927						
					RHT-PS-094-T	0.944	0.966						
					RHT-PS-100-T	1.000	1.022						
5	1 1/2"			26.9 mm	RHT-PS-105-T	1.050	1.072	1.76 (45 mm)	1.79 (46 mm)	1.00 (25.4 mm)	1.83 (46 mm)	3.17 (81 mm)	0.55 (0.25 kg)
				28 mm	RHT-PS-106-T	1.059	1.081						
					RHT-PS-110-T	1.102	1.124						
					RHT-PS-113-T	1.125	1.147						
					RHT-PS-114-T	1.142	1.164						
					RHT-PS-118-T	1.181	1.203						
					RHT-PS-131-T	1.315	1.337						
					RHT-PS-133-T	1.326	1.348						
					RHT-PS-134-T	1.338	1.360						
					RHT-PS-138-T	1.378	1.400						
6	2"			34 mm	RHT-PS-142-T	1.417	1.439	2.02 (52 mm)	2.03 (52 mm)	1.00 (25.4 mm)	2.08 (53 mm)	3.67 (93 mm)	0.60 (0.27 kg)
				35 mm	RHT-PS-142-T	1.417	1.439						
				36 mm	RHT-PS-150-T	1.500	1.522						
					RHT-PS-158-T	1.575	1.597						
					RHT-PS-161-T	1.614	1.636						
					RHT-PS-163-T	1.625	1.647						
7	2 1/2"			40 mm	RHT-PS-165-T	1.654	1.676	2.27 (58 mm)	2.28 (58 mm)	1.00 (25.4 mm)	2.31 (59 mm)	4.15 (105 mm)	0.65 (0.30 kg)
				41 mm	RHT-PS-167-T	1.689	1.691						
				42 mm	RHT-PS-190-T	1.900	1.922						
				42.4 mm	RHT-PS-200-T	2.000	2.022						
				48.3 mm	RHT-PS-205-T	2.047	2.069						
8	3"			52 mm	RHT-PS-209-T	2.087	2.109	2.76 (70 mm)	2.79 (71 mm)	1.00 (25.4 mm)	3.03 (77 mm)	5.37 (136 mm)	0.85 (0.39 kg)
				53 mm	RHT-PS-213-T	2.125	2.147						
				54 mm	RHT-PS-237-T	2.375	2.397						
				60.3 mm	RHT-PS-250-T	2.500	2.522						
9	4"			63.5 mm	RHT-PS-276-T	2.756	2.778	3.98 (101 mm)	4.46 (113 mm)	1.50 (38 mm)	4.45 (113 mm)	8.03 (204 mm)	4.20 (1.90 kg)
				70.0 mm	RHT-PS-288-T	2.875	2.897						
					RHT-PS-300-T	3.000	3.022						
					RHT-PS-313-T	3.125	3.147						
					RHT-PS-335-T	3.346	3.368						
					RHT-PS-350-T	3.500	3.522						
9	6"			85 mm	RHT-PS-400-T	4.000	4.022	3.98 (101 mm)	4.46 (113 mm)	1.50 (38 mm)	4.45 (113 mm)	8.03 (204 mm)	4.20 (1.90 kg)
				88.9 mm	RHT-PS-409-T	4.094	4.116						
					RHT-PS-413-T	4.125	4.147						
					RHT-PS-450-T	4.500	4.522						
9	6"			114.3 mm	RHT-PS-508-T	5.078	5.100	3.98 (101 mm)	4.46 (113 mm)	1.50 (38 mm)	4.45 (113 mm)	8.03 (204 mm)	4.20 (1.90 kg)
				129 mm	RHT-PS-600-T	6.000	6.022						
9	6"			154 mm	RHT-PS-606-T	6.063	6.085	3.98 (101 mm)	4.46 (113 mm)	1.50 (38 mm)	4.45 (113 mm)	8.03 (204 mm)	4.20 (1.90 kg)
					RHT-PS-613-T	6.125	6.147						

Anchors plastics are Black
Guides plastics are Gray